

MAIL TO: P.O. BOX 16347 • Louisville, KY 40256-0347
SHIP TO: 3649 Cane Run Road • Louisville, KY 40211-1961
Tel: (502) 778-2731 • 1 (800) 928-PUMP

Visit our website:
zoellerengineered.com

Product information presented here reflects conditions at time of publication. Consult factory regarding discrepancies or inconsistencies.

X6280 - X6290 HAZARDOUS LOCATION SERIES

CLASS I, DIVISION 1, GROUP C & D
CLASS I, ZONE 1, GROUPS IIA & IIB
DIMENSIONAL DATA

*2" & 3" NPT Vertical Discharge Units
Commercial Duty Sewage Floor Mounted*



24 INCH DIAMETER
MINIMUM FOR SIZE ONLY.
VOLUME MAY REQUIRE
LARGER BASIN.

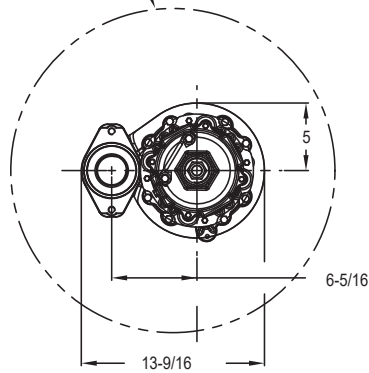

SIMPLEX INSTALLATION

30 INCH DIAMETER
MINIMUM FOR SIZE ONLY.
VOLUME MAY REQUIRE
LARGER BASIN.

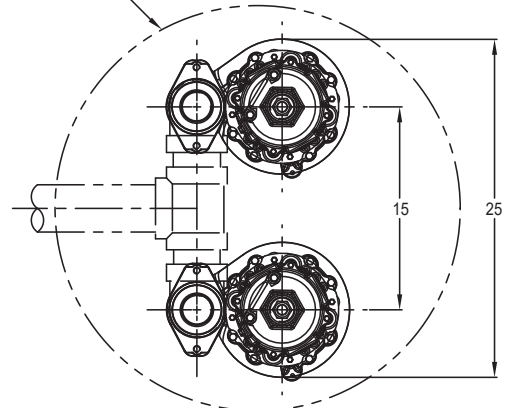

DUPLEX INSTALLATION

DIMENSIONS BASED ON STANDARD ANSI FITTING SIZES.
CHECK VALVES REQUIRED, NOT SHOWN FOR CLARITY.
ALL DIMENSIONS ARE IN INCHES UNLESS OTHERWISE NOTED.

CHECK VALVE
(P/N 30-0152 2 INCH NPT.)
(P/N 6030-0160 3 INCH NPT)

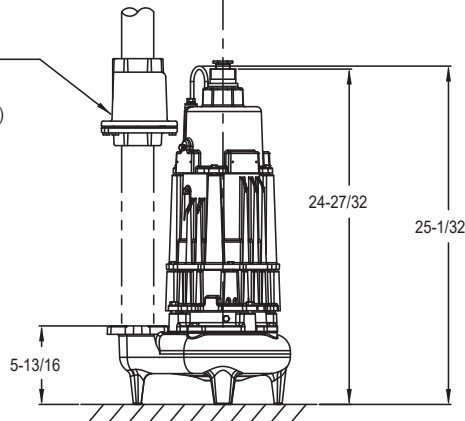

SK1990

*All dimensions in inches unless otherwise noted.

X6280 - X6290 HAZARDOUS LOCATION SERIES



CLASS I, DIVISION 1, GROUP C & D
 CLASS I, ZONE 1, GROUPS IIA & IIB
DIMENSIONAL DATA
2" & 3" NPT Vertical Discharge Units
Commercial Duty Sewage Rail Mounted



DISCHARGE	A	B	C	D	E	F
2 INCH	24	19-27/32	1-9/16	26-13/32	26-5/8	18-19/32
3 INCH	30	21-5/8	3-9/32	28-3/32	28-5/16	19-11/16

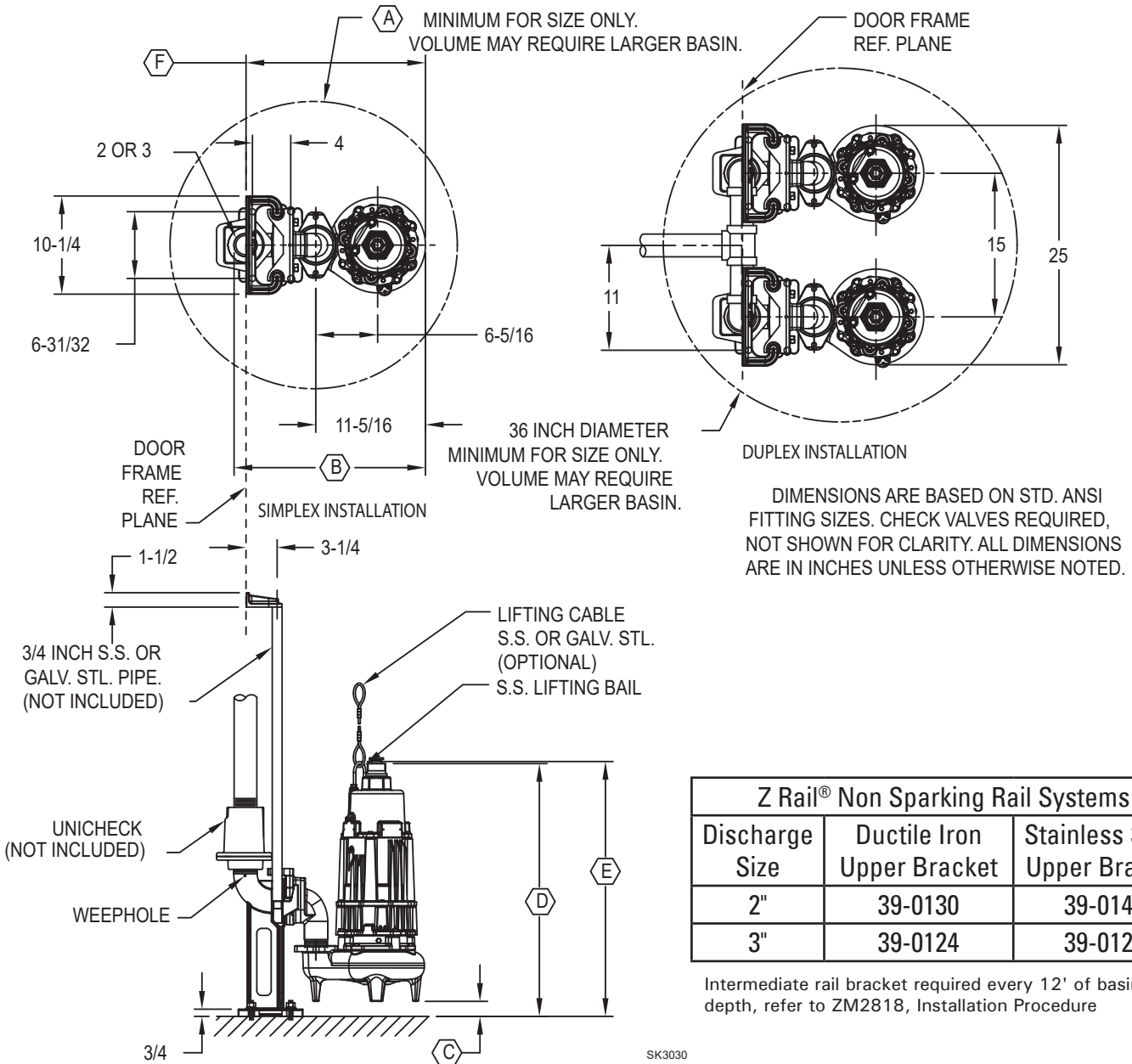

Z Rail® Non Sparking Rail Systems		
Discharge Size	Ductile Iron Upper Bracket	Stainless Steel Upper Bracket
2"	39-0130	39-0141
3"	39-0124	39-0125

Intermediate rail bracket required every 12' of basin depth, refer to ZM2818, Installation Procedure

*All dimensions in inches unless otherwise noted.

See Reverse Side for "Floor Mounted"